

订购标示法

ORDERING INDICATION

KHS - MF 25 S R×90 - E - P



KHS	系列 Series	KHS				
MF F(M)	类型 Type	空白：配管式 Blank: Line type	TB：全牙型 TB: Threaded body			
		F(M): 油路板式 F(M): Manifold type	MF: 油路板附调速 MF: Manifold with flow control			
25	油缸内径 Cylinder inside diameter	Φ 25	Φ 32	Φ 40	Φ 50	Φ 63
S	压板型式 Clamping arm type	S: 单边压板 S: Single side arm	D: 双边压板 D: Double side arm			
R	转角方向 Rotating direction	R: 顺时针右转 R: Turn right	L: 逆时针左转 L: Turn left	N: 0° 不旋转 N: 0° No swing		
90	转角角度 Rotating angle	标准角度 Standard angle 90° (±2°) 订做角度 Order angle 0°, 45° (±2°), 60° (±2°)				
E	行程加长 Stroke extension					
P	精密定位型 Precision position	增加定位销设计, 提高转角重复精度 Add locating pin design, to improve the repeat precision of rotation angle				

注：订精密定位型请来电咨询

SINGLE SIDE SWING CLAMP

单边压板旋转示意图

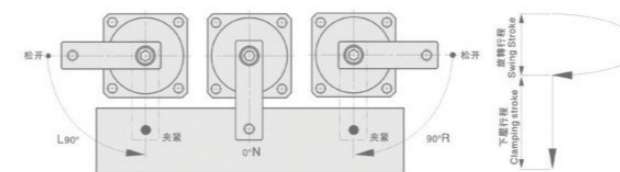

▲注：转角方向是指下压时转角方向

CLAMPING ARM MOUNTING METHODS

压板锁紧操作方式



DOUBLE SIDE SWING CLAMP

双边压板旋转示意图

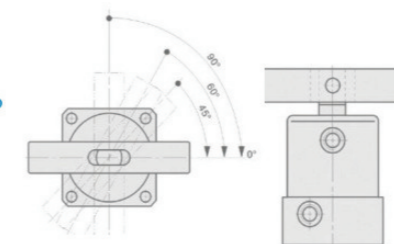

CLAMPING ARM REMOVING METHODS

压板拆卸操作方式



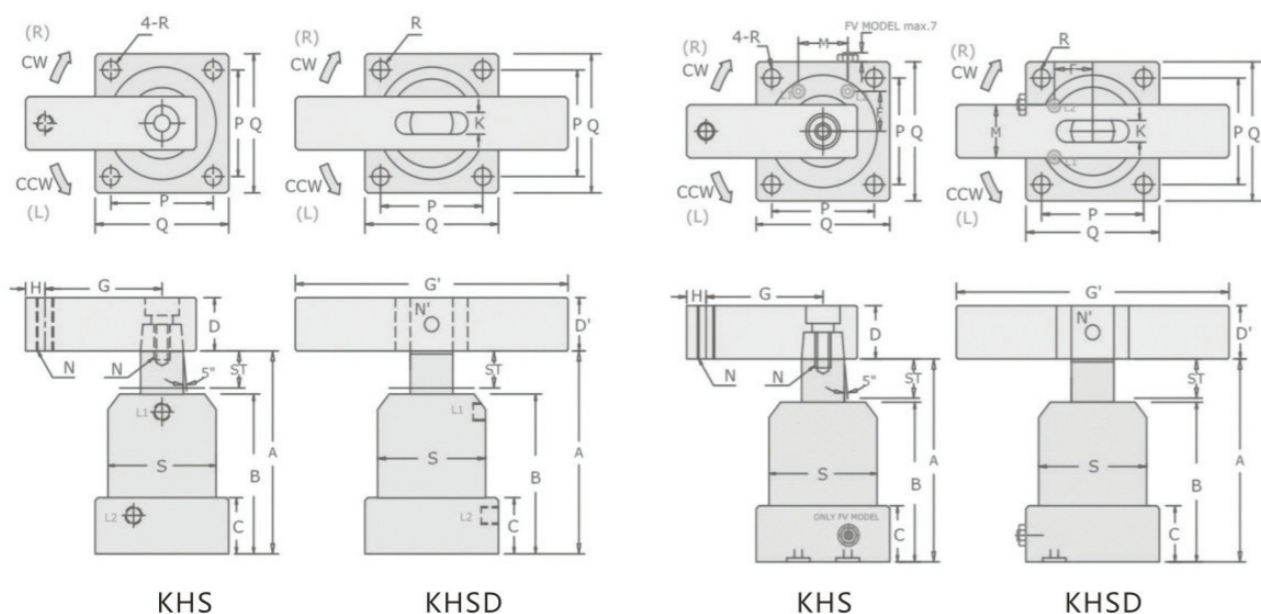

unit 单位: mm

四方底座型 flang type	KHS-25 KHSD-25	KHS-32 KHSD-32	KHS-40 KHSD-40	KHS-50 KHSD-50	KHS-63 KHSD-63
最大使用压力 max.pressure	70kg/cm ²				
一般使用压力 normal pressure	20-45kg/cm ²				
缸体运行方式 acting type	复动 double acting				
转角度数 swivel angle	90°(0°,45°,60°)±2°				
转角行程 swivel stroke	12	14	14	14	14
夹紧行程 clamping stroke	14	15	15	15	15
活塞直径 bore dia.	25	32	40	50	63
活塞杆径 piston rod dia.	18	20	20	20	25
理论压力(25kg/cm ²) clamping force	59kg	125kg	200kg	400kg	600kg
A放松状态 unclamp	100	111	113.6	114.5	118
B	70	76	80	80	85
C	23	25	27	27	32
D	□25.4	□25.4	□25.4	□25.4	□32
D'	□19	□22	□22	□22	□25.4
G	50	55	55	55	75
G'	100	120	120	120	140
H	10	10	10	10	11
K	9	10	10	10	12
油孔L1(夹紧clamp)/L2(放松unclamp)	1/8PT	1/8PT	1/8PT	1/8PT	1/8PT
油路板型O-ring Manifold	S4	S4	S4	S4	S4
N	M10×1.5	M10×1.5	M10×1.5	M10×1.5	M12×1.75
N'	φ8	φ8	φ8	φ8	φ10
P	40	44	48	57	70
Q	50	55	62	74	88
R	φ6.5	φ6.5	φ8.5	φ8.5	φ10.5
S	φ45	φ50	φ54	φ65	φ80
M	18	24	26	30	40
F	15	17	20	25	30
weight 重量 kg	0.8	1.0	1.1	1.4	2.3

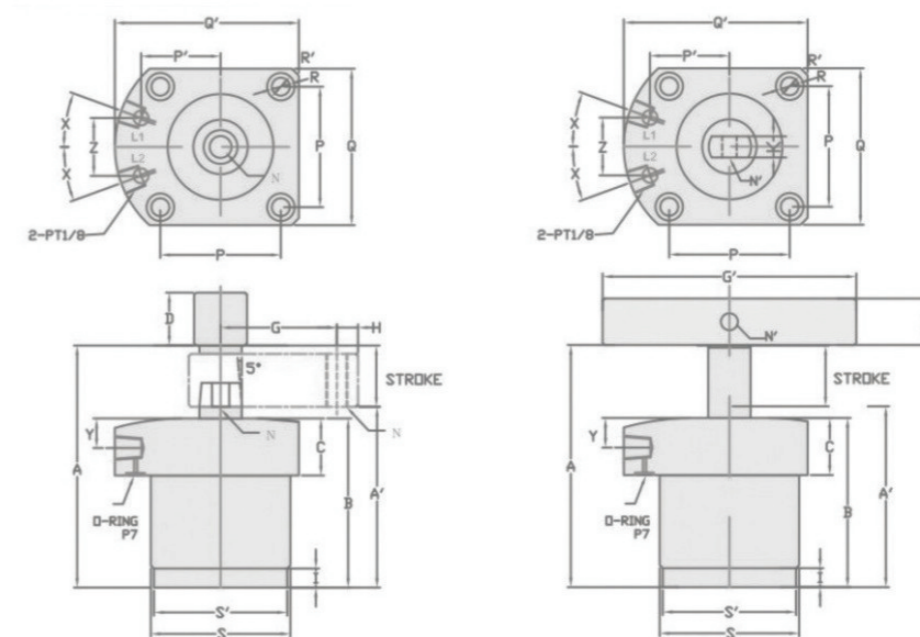

unit 单位: mm

上安装型式 upper flange type	KHU-32 KHUD-32	KHU-40 KHUD-40	KHU-50 KHUD-50	KHU-63 KHUD-63
最大使用压力 max.pressure	70kg/cm ²			
一般使用压力 normal pressure	20-45kg/cm ²			
缸体运行方式 acting type	复动 double acting			
转角度数 swivel angle	90°(0°,45°,60°)±2°			
转角行程 swivel stroke	14	14	14	14
夹紧行程 clamping stroke	15	15	15	15
活塞直径 bore dia.	32	40	50	63
活塞杆径 piston rod dia.	20	20	20	25
理论压力(25kg/cm ²) clamping force	125kg	200kg	400kg	600kg
A未夹最高点 unclamp	111	114	114.5	118
A' 夹紧最低点 clamp	82	85	85.5	89
B	76	80	80	85
C	25	27	27	32
D	□25.4	□25.4	□25.4	□25.4
D'	□22	□22	□22	□22
G	55	55	55	75
G'	120	120	120	140
H	10	10	10	11
I	9	9	9	9
K	10	10	10	12
L1(夹紧clamp)/L2(放松unclamp)	1/8PT	1/8PT	1/8PT	1/8PT
油路板型O-ring Manifold	P7	P7	P7	P7
N	M10×1.5	M10×1.5	M10×1.5	M12×1.75
N'	φ8	φ8	φ8	φ10
P/P'	44/30	48/31.4	57/37.6	70/46
Q/Q'	55/68.5	62/71.5	74/87	88/105.5
R/R'	φ6.5/11	φ6.5/11	φ8.5/14	φ8.5/14
S	M50×1.5	M55×1.5	M65×1.5	M80×1.5
S'	49	53	63	77
X(角度)	22.5°	22.5°	20°	22.5°
Y	12.5	14	14	19
Z	24.9	26	27.4	38
weight 重量 kg	1.0	1.1	1.3	2.3

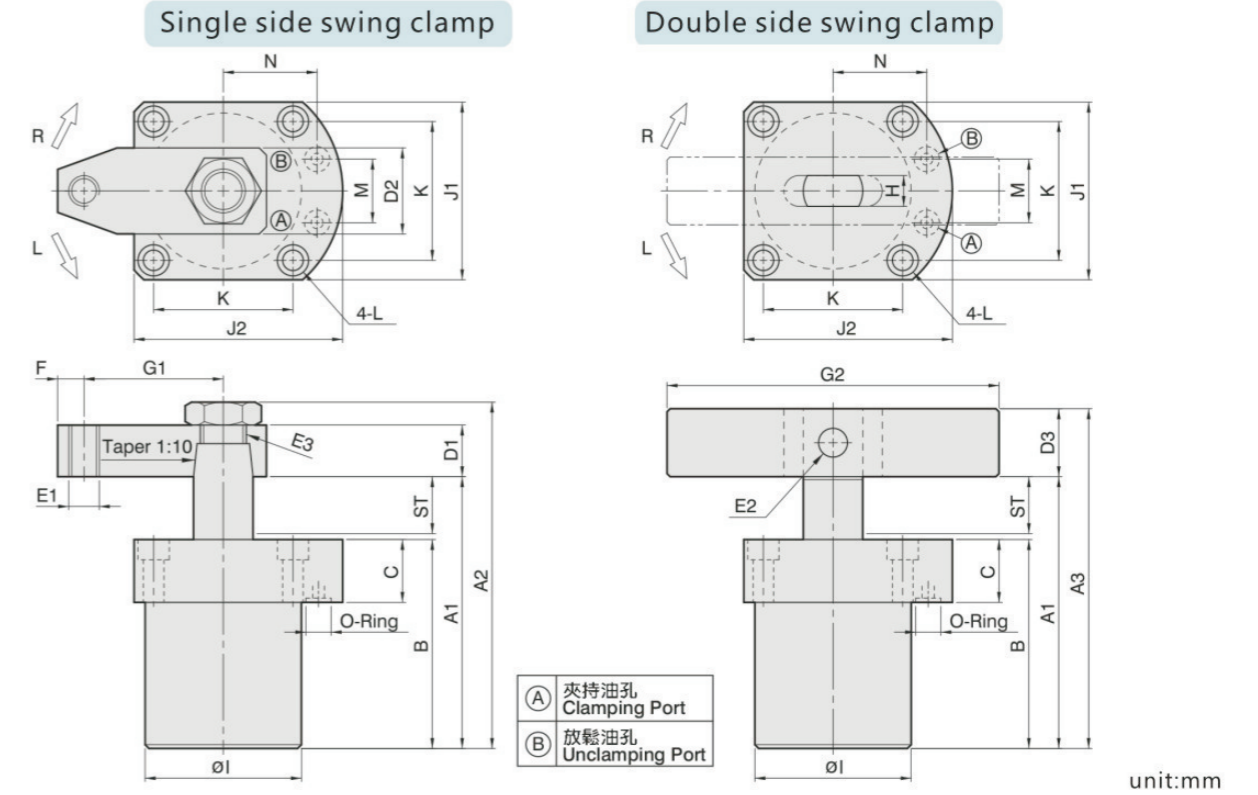
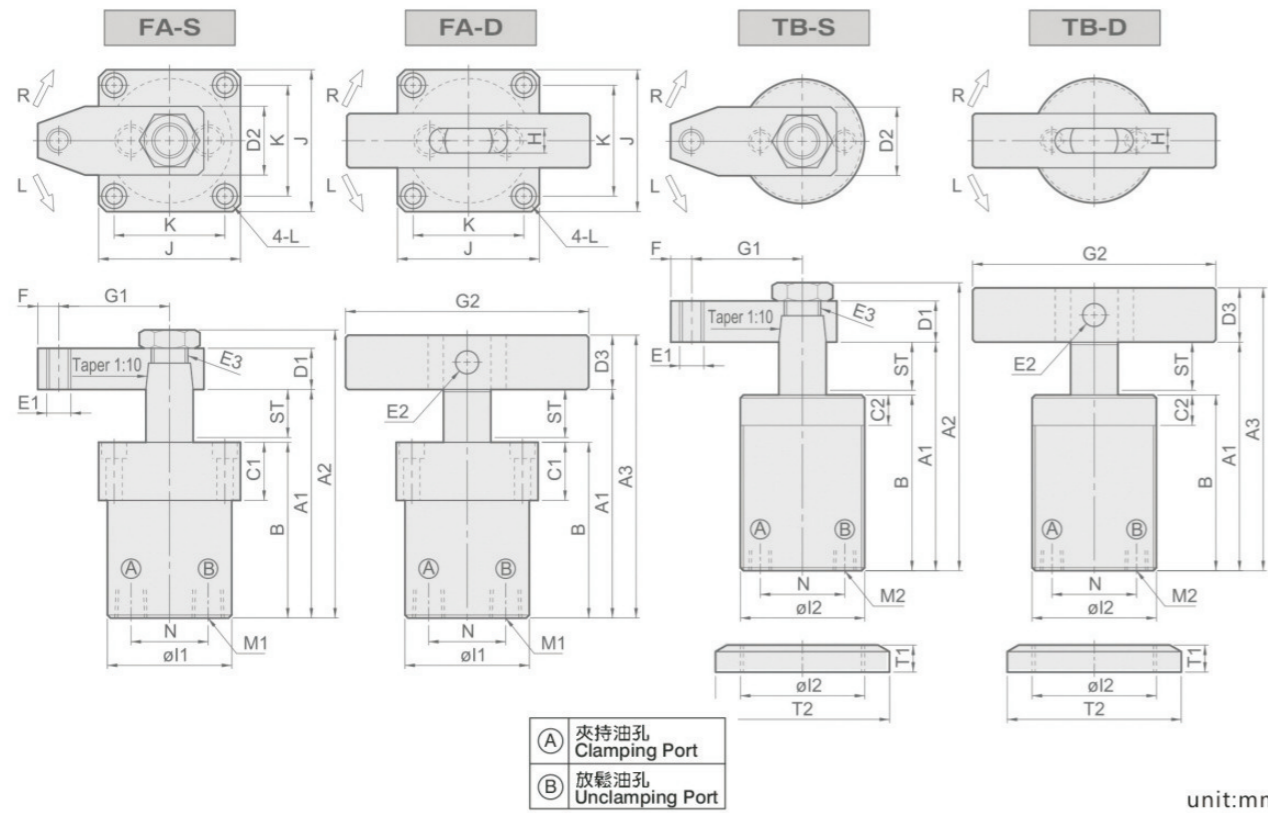

ITEM	MODEL	KHSC-FA25 KHSC-TB25	KHSC-FA32 KHSC-TB32	KHSC-FA40 KHSC-TB40	KHSC-FA50 KHSC-TB50	KHSC-FA63
ST:Swing/Claming		22:9/13	26:11/15	26:11/15	30:13/17	30:13/17
A1		101	115	120	134	139
A2		(124)	(140)	(148)	(166)	(175)
A3		120	137.2	142.2	159.4	170.8
B		76	85	90	100	105
C1		22	25	25	30	30
C2		12	12	15	15	-
D1		15	17	18	20	23
D2		27	31	31	37	48
D3		□19	□22.2	□22.2	□25.4	□31.8
E1		M10×1.5	M10×1.5	M10×1.5	M12×1.75	M16×2.0
E2		φ8	φ8	φ10	φ12	φ15
E3		M14×1.5	M16×1.5	M18×1.5	M20×1.5	M26×1.5
F		10	10	10	12	15
G1		50	55	60	65	75
G2		140	160	160	180	200
H		9	10	10	12	15
φI1		φ45	φ50	φ58	φ68	φ81
φI2		M45×1.5	M50×1.5	M55×1.5	M65×1.5	-
J		53	57	69	75	90
K		40	44	62	58	70
L		φ6.8-φ10.5×6.5D.	φ6.8-φ10.5×6.5D.	φ9-φ14×9D.	φ9-φ14×9D.	φ11-φ17×11D.
M1		PT1/4	PT1/4	PT1/4	PT1/4	PT1/4
M2		PT1/8	PT1/8	PT1/8	PT1/8	-
N		28	32	40	50	63
T1×2PCS		10	11	11	12	-
T2		φ65	φ70	φ75	φ85	-

ITEM	MODEL	KHSC-FAM25	KHSC-FAM32	KHSC-FAM40	KHSC-FAM50
ST:Swing/Claming		22:9/13	26:11/15	26:11/15	30:13/17
A1		101	115	120	134
A2		(124)	(140)	(148)	(166)
A3		120	137.2	142.2	159.4
B		76	85	90	100
C		22	25	25	30
D1		15	17	18	20
D2		27	31	31	37
D3		□19	□22.2	□22.2	□25.4
E1		M10×1.5	M10×1.5	M10×1.5	M12×1.75
E2		φ8	φ8	φ10	φ12
E3		M14×1.5	M16×1.5	M18×1.5	M20×1.5
F		10	10	10	12
G1		50	55	60	65
G2		140	160	160	180
H		9	10	10	12
φI		φ45	φ50	φ58	φ68
J1		55	57	69	75
J2		64	65.5	79	87
K		42	44	52	58
L		φ6.8-φ10.5×6.5D.	φ6.8-φ10.5×6.5D.	φ9-φ14×9D.	φ9-φ14×9D.
M		20	22	26	30
N		28	29	34.5	39
O-Ring		P6	P6	P9	P9

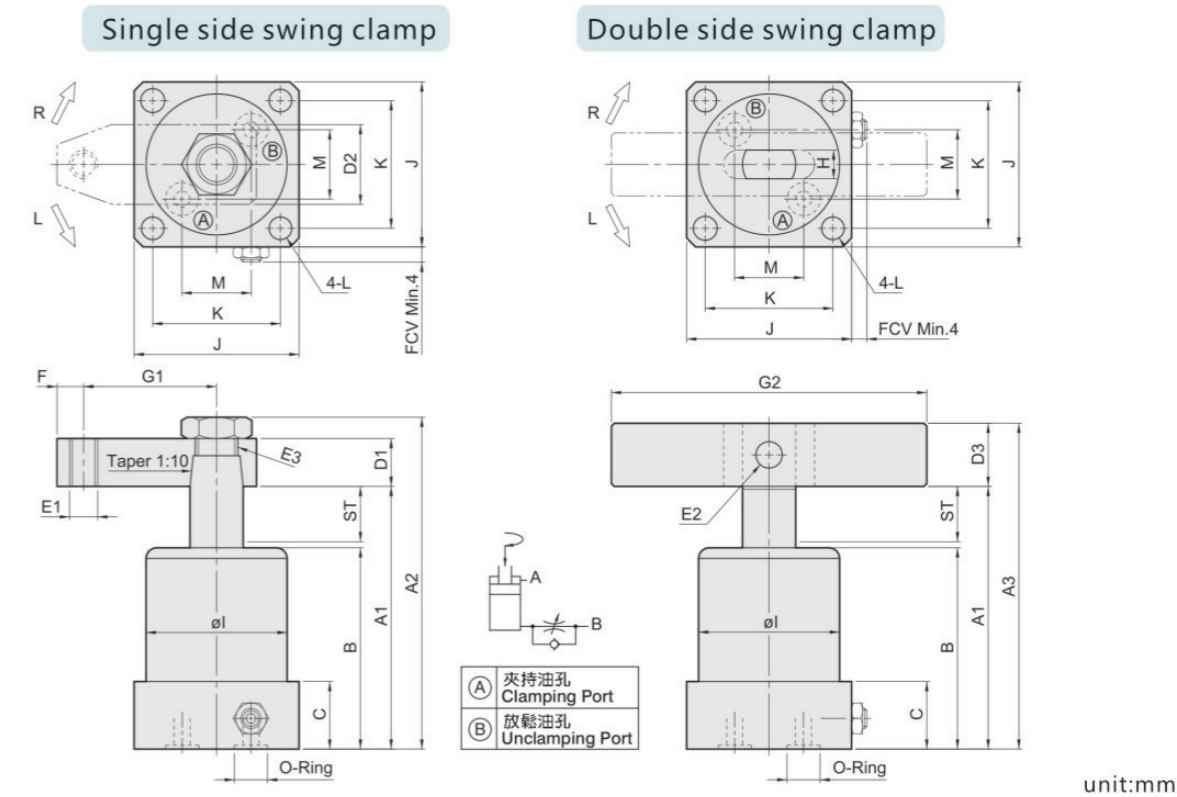
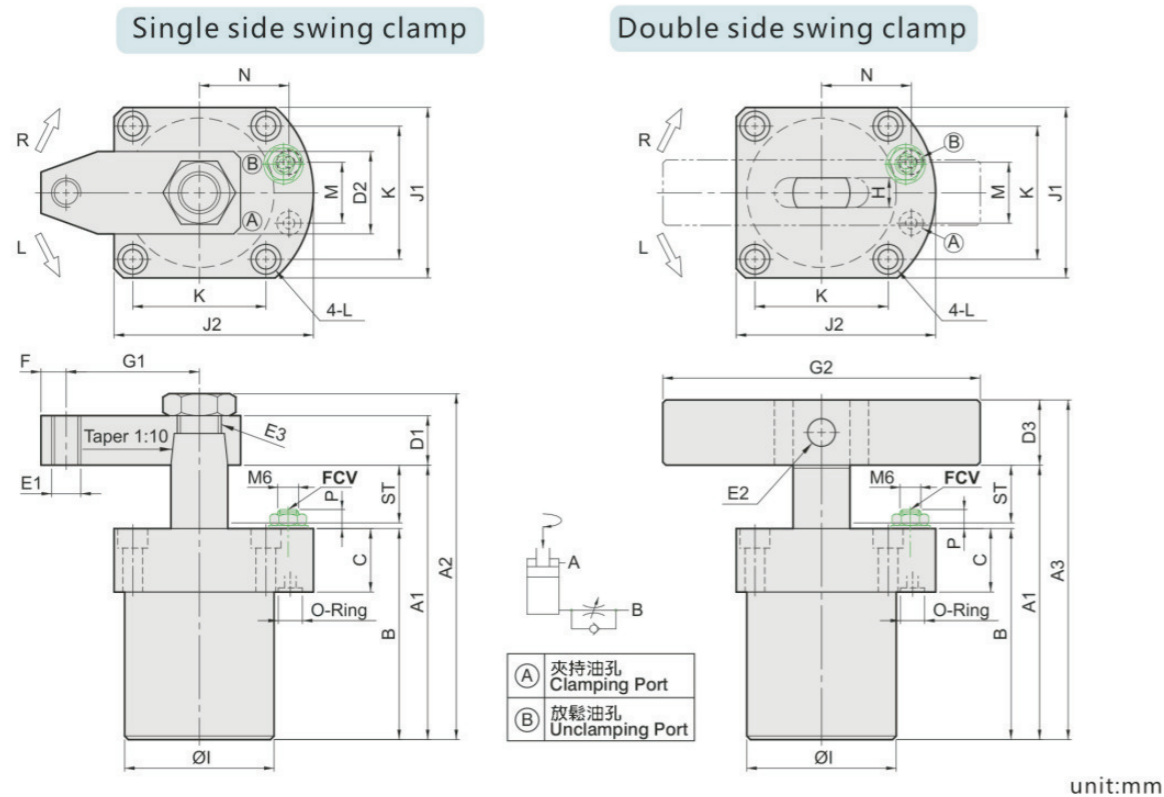

ITEM	MODEL	KHSC-FCM25	KHSC-FCM32	KHSC-FCM40	KHSC-FCM50	KHSC-FCM63
ST:Swing/Claming		22:9/13	26:11/15	26:11/15	30:13/17	30:13/17
A1		101	115	120	134	139
A2		(124)	(140)	(148)	(166)	(175)
A3		120	137.2	142.2	159.4	170.8
B		76	85	90	100	105
C		22	25	25	30	30
D1		15	17	18	20	23
D2		27	31	31	37	48
D3		□19	□22.2	□22.2	□25.4	□31.8
E1		M10×1.5	M10×1.5	M10×1.5	M12×1.75	M16×2.0
E2		φ8	φ8	φ10	φ12	φ15
E3		M14×1.5	M16×1.5	M18×1.5	M20×1.5	M26×1.5
F		10	10	10	12	15
G1		50	55	60	65	75
G2		140	160	160	180	200
H		9	10	10	12	15
φl		φ45	φ50	φ58	φ68	φ81
J1		55	57	69	75	90
J2		64	65.5	79	87	104
K		42	44	52	58	70
L		φ6.8-φ10.5×6.5D.	φ6.8-φ10.5×6.5D.	φ9-φ14×9D.	φ9-φ14×9D.	φ11-φ17×11D.
M		20	22	26	30	34
N		28	29	34.5	39	47
O-Ring		P6	P6	P9	P9	P9
P Min		7	4.5	4.5	4	4
P Max		9.9	7.8	7.8	7.3	7.3

ITEM	MODEL	KHSC-MF25	KHSC-MF32	KHSC-MF40	KHSC-MF50	KHSC-MF63				
ST:Swing/Claming		22:9/13	26:11/15	41:11/30	26:11/15	40:11/30	30:13/17	47:13/34	30:13/17	47:13/34
A1		101	115	145	120	150	134	168	139	173
A2		(124)	(140)	(170)	(148)	(178)	(166)	(200)	(175)	(209)
A3		120	137.2	167.2	142.2	172.2	159.4	193.4	170.8	204.8
B		76	85	100	90	105	100	117	105	122
C		22	25	25	30	30	30	30	30	30
D1		15	17	18	20	23	20	20	23	23
D2		27	31	31	37	48	37	37	48	48
D3		□19	□22.2	□22.2	□25.4	□31.8	□25.4	□25.4	□31.8	□31.8
E1		M10×1.5	M10×1.5	M10×1.5	M12×1.75	M16×2.0	M10×1.5	M10×1.5	M12×1.75	M16×2.0
E2		φ8	φ8	φ10	φ12	φ15	φ8	φ8	φ10	φ15
E3		M14×1.5	M16×1.5	M18×1.5	M20×1.5	M26×1.5	M14×1.5	M16×1.5	M18×1.5	M20×1.5
F		10	10	10	12	15	10	10	12	15
G1		50	55	60	65	75	50	55	60	75
G2		140	160	160	180	200	140	160	160	200
H		9	10	10	12	15	9	10	10	15
φl		φ46	φ50	φ54	φ66	φ80	φ46	φ50	φ54	φ66
J		55	57	63	72	88	55	57	63	88
K		42	44	48	57	70	42	44	48	70
L		φ6.8	φ6.8	φ9	φ9	φ11	φ6.8	φ6.8	φ9	φ11
M		19	21	23	28	32	19	21	23	32
O-Ring		P7	P7	P9	P9	P9	P7	P7	P9	P9

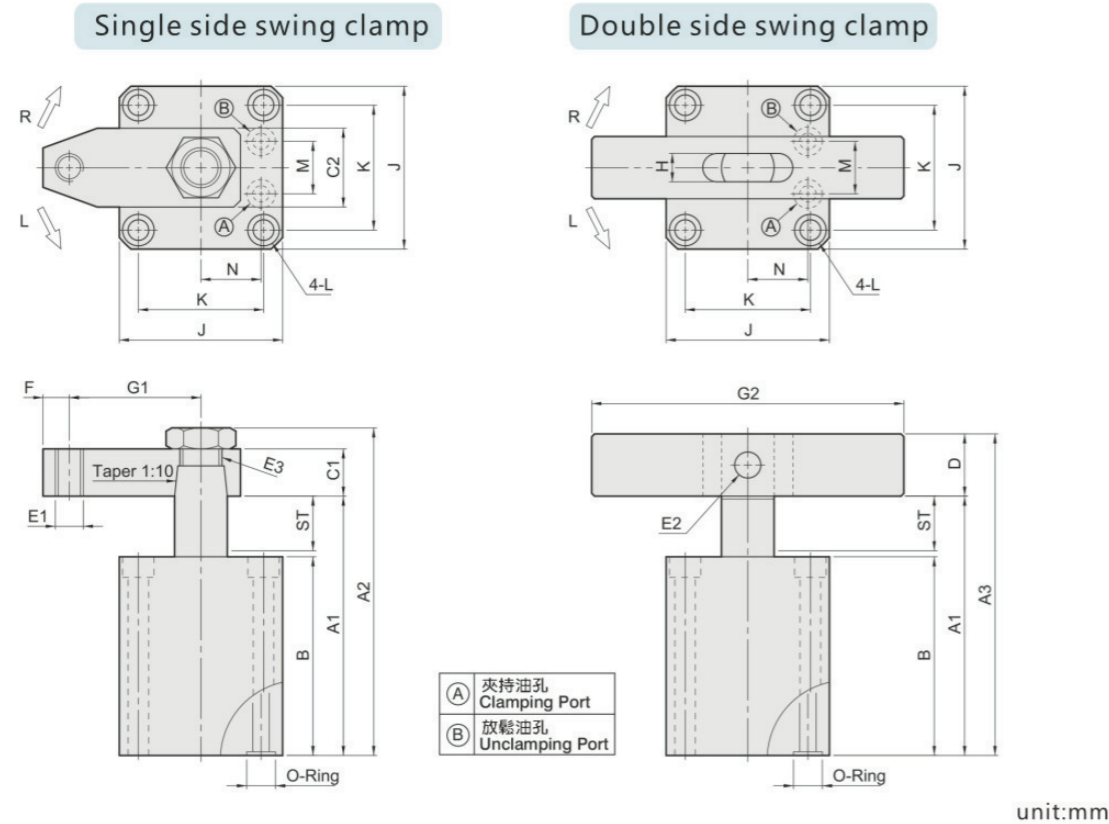

MODEL	KHSC-M25	KHSC-M32	KHSC-M40	KHSC-M50
ITEM				
ST:Swing/Claming	22:9/13	26:11/15	26:11/15	30:13/17
A1	101	115	120	134
A2	(124)	(140)	(148)	(166)
A3	120	137.2	142.2	159.4
B	76	85	90	100
C1	15	17	18	20
C2	27	31	31	37
D	□19	□22.2	□22.2	□25.4
E1	M10×1.5	M10×1.5	M10×1.5	M12×1.75
E2	φ8	φ8	φ10	φ12
E3	M14×1.5	M16×1.5	M18×1.5	M20×1.5
F	10	10	10	12
G1	50	55	60	65
G2	140	160	160	180
H	9	10	10	12
J	55	57	69	75
K	42	44	52	58
L	φ 6.8-φ 10.5×6.5D.	φ 6.8-φ 10.5×6.5D.	φ 9-φ 14×9D.	φ 9-φ 14×9D.
M	18	22	26	32
N	20	22	26	30
O-Ring	P7	P7	P8	P8